

The Hana Advisory Committee to the Maui Planning Commission will reconvene its recessed March 9, 2015 meeting at 4 pm on March 17, 2015 at the Old Hana School Cafeteria, 5091 Uakea Road, Hana, Island of Maui to finish their deliberations on the Thomas Hoeffken State Special Use Permit request. The public hearing on this matter was closed on March 9, 2015.

PURSUANT TO CHAPTER 92, PART I, OF THE HAWAII REVISED STATUTES AS AMENDED, NOTICE IS HEREBY GIVEN OF A MEETING OF THE HANA ADVISORY COMMITTEE TO THE MAUI PLANNING COMMISSION

## HANA ADVISORY COMMITTEE AGENDA

### SITE VISIT AND PUBLIC MEETING

RECEIVED  
2015 MAR 11 PM 3 21  
OFFICE OF THE  
COUNTY CLERK

#### SITE VISIT:

DATE: MARCH 17, 2015  
TIME: 2:00 p.m.  
PLACE: TMK No. (2) 1-3-004:001  
Meet at driveway entrance to 4356 Hana Highway, Hana, Island of Maui  
(Please see attached map for directions.)

#### PUBLIC MEETING:

DATE: MARCH 17, 2015  
TIME: 4:00 p.m.  
PLACE: Old Hana School Cafeteria, 5091 Uakea Road, Hana, Island of Maui

Members: Clayton Carvahlo, Jr. (Chair), Ward Mardfin (Vice-Chair), Ian Ballantyne, John Blumer-Buell, Edward Cashman, Scott Crawford, Anjoleen Hoopai-Waikoloa

- A. CALL TO ORDER
- B. PUBLIC TESTIMONY - At the discretion of the Chair, public testimony may also be taken when each agenda item is discussed, except for contested cases under Chapter 91, HRS. Individuals who cannot be present when the agenda item is discussed may testify at the beginning of the meeting instead and will not be allowed to testify again when the agenda item is discussed unless new or additional information will be offered.
- C. DISSOLVE TEMPORARY INVESTIGATIVE GROUP \*
- D. SITE VISIT OF A PORTION OF TMK No. (2) 1-3-004:001.  
*Meeting will be recessed after the site visit and will reconvene at 4:00 p.m. at the Old Hana School Cafeteria, 5091 Uakea Road, Hana, Island of Maui.*
- E. UNFINISHED BUSINESS (Action to be taken after public hearing.)
  - 1. MR. WAYNE I. ARAKAKI, of WAYNE I. ARAKAKI ENGINEERING, LLC, on behalf of MR. THOMAS HOEFFKEN, requesting a State Land Use Commission Special Use Permit for the mining and resource extraction of rock to be processed as aggregate for roadway maintenance on approximately 12 acres of land located next to Kawaipapa Stream in the State Agricultural District, TMK: 1-3-004: 001 (por.), Hana, Island of Maui. (SUP2 2014/0002) (S. Lopez) (*Committee Members: Please bring your documents.*)
- F. ADJOURNMENT

AGENDA ITEMS ARE SUBJECT TO CANCELLATION.

EACH APPLICANT IS REQUESTED TO PROVIDE RESPONSIBLE REPRESENTATION AT THE MEETING.

DOCUMENTS ARE FILED WITH THE PLANNING DEPARTMENT.

\* AN EXECUTIVE SESSION MAY BE CALLED IN ORDER FOR THE COMMISSION TO CONSULT WITH ITS ATTORNEY ON QUESTIONS AND ISSUES PERTAINING TO THE COMMISSION'S POWERS, DUTIES, PRIVILEGES, IMMUNITIES AND LIABILITIES, PURSUANT TO SEC. 92-5(a)(4), HRS.

DOCUMENTS ARE ON FILE WITH THE DEPARTMENT OF PLANNING. THE ADDRESS OF THE COMMITTEE IS C/O DEPARTMENT OF PLANNING, ONE MAIN PLAZA, 2200 MAIN STREET, SUITE 315, WAILUKU, MAUI, HAWAII 96793.

ORAL OR WRITTEN TESTIMONY WILL BE RECEIVED ON EACH ANY AGENDA ITEM SUBJECT TO THE PROVISIONS OF CHAPTER 92, HAWAII REVISED STATUTES AND THE COMMISSION'S RULES OF PRACTICE AND PROCEDURE.

UNLESS OTHERWISE SPECIFIED BY ANOTHER SPECIFIC PLANNING COMMISSION RULE, ANY PETITION TO INTERVENE AS A FORMAL PARTY IN THE PROCEEDINGS BEFORE THE MAUI PLANNING COMMISSION MUST BE FILED WITH THE COMMISSION AND SERVED UPON THE APPLICANT NO LESS THAN TEN (10) DAYS BEFORE THE FIRST PUBLIC HEARING DATE. (NOTE: THE CALCULATION OF TIME FOR DEADLINES TEN DAYS OR LESS EXCLUDES WEEKENDS AND STATE RECOGNIZED HOLIDAYS.) THE ADDRESS OF THE COMMITTEE IS C/O THE DEPARTMENT OF PLANNING, ONE MAIN PLAZA, 2200 MAIN STREET, SUITE 315, WAILUKU, MAUI, HAWAII 96793. THE DEADLINE FOR FILING A TIMELY PETITION TO INTERVENE FOR AN ITEM WHERE THE FIRST PUBLIC HEARING DATE IS MARCH 9, 2015 WAS ON FEBRUARY 23, 2015..

WRITTEN TESTIMONY AND FAXES SHOULD BE RECEIVED AT LEAST TWO (2) BUSINESS DAYS BEFORE THE MEETING TO ENSURE DISTRIBUTION TO THE COMMISSION. FIFTEEN (15) COPIES OF WRITTEN TESTIMONY ARE REQUESTED IF TESTIMONY IS PRESENTED IMMEDIATELY PRIOR TO OR AT THE MEETING.

TESTIFIERS: PLEASE BE ADVISED THAT APPLICATIONS FOR COMMUNITY PLAN AMENDMENT, STATE DISTRICT BOUNDARY RECLASSIFICATION, CHANGE IN ZONING, AND CONDITIONAL PERMIT REQUIRE THE APPROVAL OF THE MAUI COUNTY COUNCIL. IN ORDER TO BE NOTIFIED OF FUTURE AGENDAS OF THE MAUI COUNTY COUNCIL PLEASE NOTIFY THE OFFICE OF COUNCIL SERVICES AT (808) 270-7838 OR BY MAIL TO THE MAUI COUNTY COUNCIL, 200 S. HIGH STREET, WAILUKU, MAUI, HAWAII 96793.

THOSE PERSONS REQUESTING SPECIAL ACCOMMODATIONS DUE TO DISABILITIES, PLEASE CALL THE DEPARTMENT OF PLANNING AT 270-7735 (Maui) OR 1-800-272-0117 (Molokai) OR 1-800-272-0125 (Lanai) OR NOTIFY THE DEPARTMENT OF PLANNING IN WRITING AT ONE MAIN PLAZA, 2200 MAIN STREET, SUITE 315, WAILUKU, MAUI, HAWAII 96793 OR FAX NUMBER 270-7634; AT LEAST SIX (6) BUSINESS DAYS BEFORE THE SCHEDULED MEETING.

**PLEASE NOTE:** If any member of the **Committee** is unable to attend the scheduled meeting, please contact the **Department of Planning** at least two days prior to the meeting date. Thank you for your cooperation. S:\ALL\SUZETTE\HAC\Agendas\2015 Agendas\031715hac\_agenda.wpd

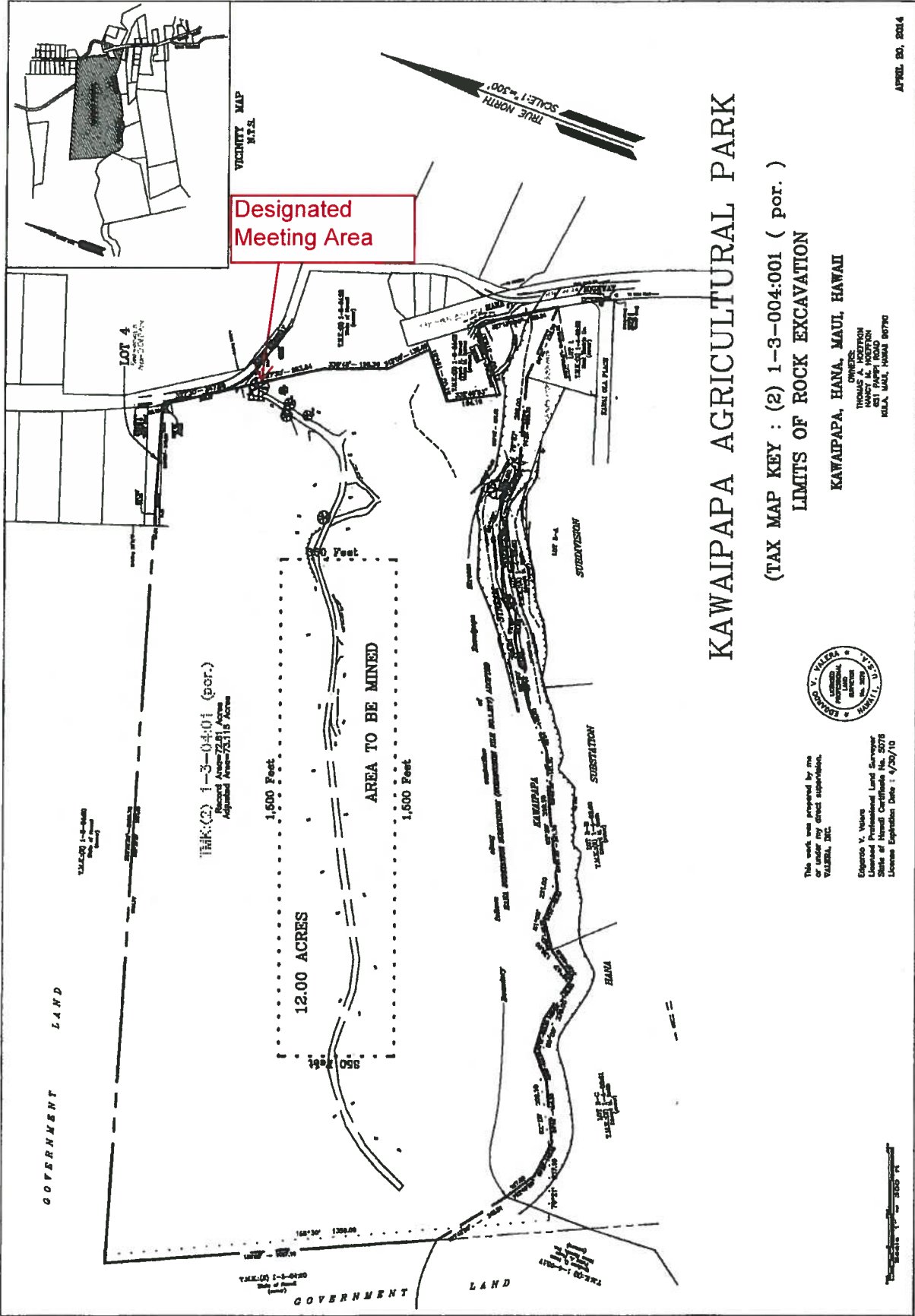

TRK(2) 1-3-04:01 (por.)  
 Record Area: 23.1 Acres  
 Adjusted Area: 7.516 Acres

Designated Meeting Area

# KAWAIPAPA AGRICULTURAL PARK

(TAX MAP KEY : (2) 1-3-004:001 ( por. )  
 LIMITS OF ROCK EXCAVATION



This work was prepared by me or under my direct supervision.  
 EDWARD V. WEISS  
 VALDESA, INC.

Edward V. Weiss  
 Licensed Professional Land Surveyor  
 State of Hawaii Certificate No. 2078  
 License Expiration Date: 4/30/10

OWNERS:  
 TRACY A. HOUSTON  
 WENDY A. HOUSTON  
 621 PAPER ROAD  
 KILAUEA, MAUI, HAWAII 96790

APRIL 29, 2014

Scale: 1" = 300'